



HEATHROW BOULEVARD 4

CURRENT AVAILABILITY

FIRST FLOOR

- SUITE 1:** 1,115 SQ FT (104 SQ M)
- SUITE 2:** 1,420 SQ FT (132 SQ M)
- SUITE 4:** 1,342 SQ FT (125 SQ M)
- SUITE 7:** 1,124 SQ FT (104 SQ M)

■ AVAILABLE ■ OCCUPIED

- #### PARKING SPACES
- SUITE 1** - 4 SPACES
 - SUITE 2** - 5 SPACES
 - SUITE 4** - 4 SPACES
 - SUITE 7** - 4 SPACES



"We have rented office space at Heathrow Boulevard for over 5 years now and have developed a great working relationship with Orbit Southern. The proximity to the Airport allows us easy access to our project sites there and to be close by to our customers, which is vital for our business. It is also very convenient for our staff who regularly travel on business."

Joanne Hughes, Executive Assistant & Office Manager, Beumer Group UK Ltd



HEATHROW BOULEVARD 4

CURRENT AVAILABILITY

GROUND FLOOR

- SUITE 2:** 1,420 SQ FT (132 SQ M)
- SUITE 5:** 6,540 SQ FT (608 SQ M)

■ AVAILABLE ■ OCCUPIED

- #### PARKING SPACES
- SUITE 2** - 5 SPACES
 - SUITE 5** - 22 SPACES

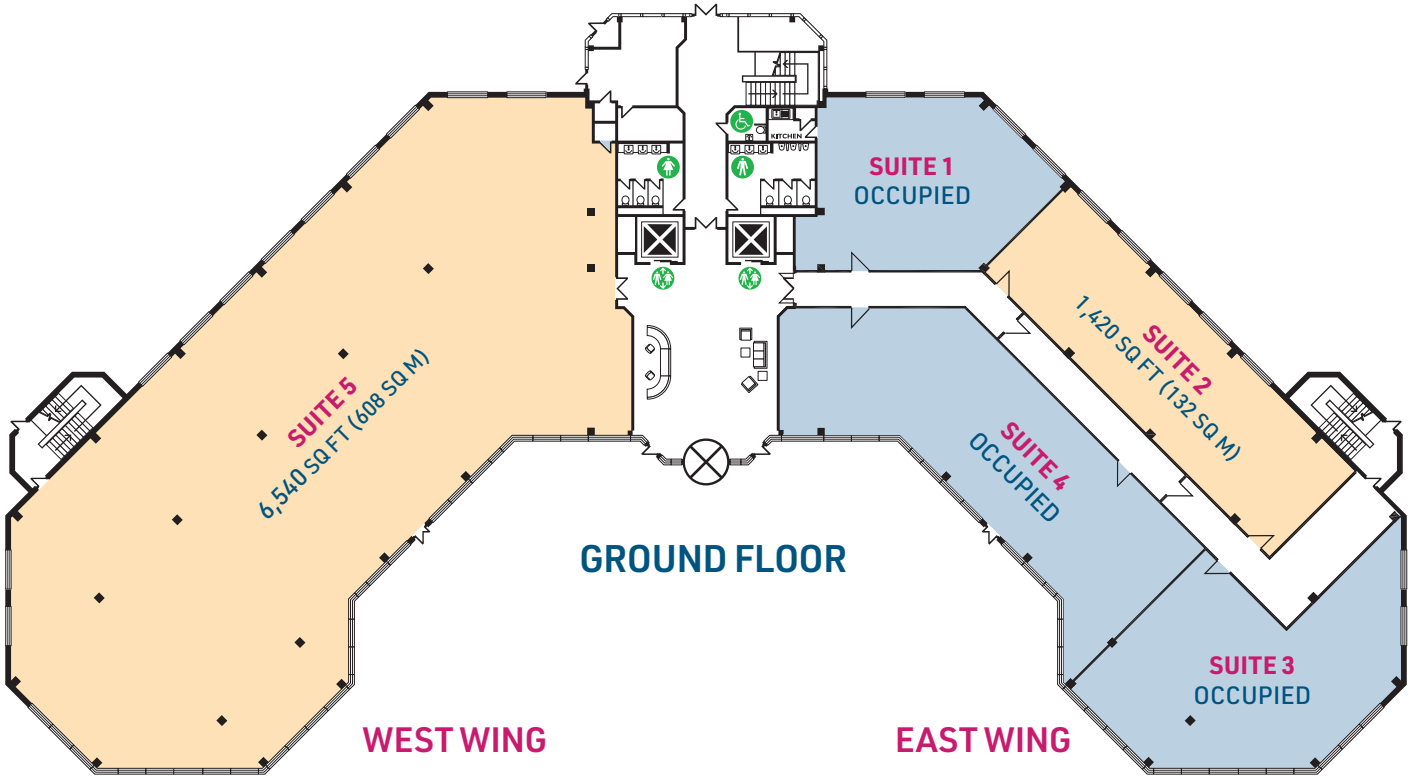

"Firstco have based our Airport Engineering Team at Heathrow Boulevard. This places us close to one of our key clients and offers flexible office space within a well-maintained business park. This is our second office with Orbit Southern and we look forward to continuing the relationship further in the future."

Steve Ikin, Associate Director, Firstco Ltd