



HEATHROW BOULEVARD 4 CURRENT AVAILABILITY FLOOR PLANS

* THREE REMAINING OFFICE SUITES ON THE FIRST FLOOR

- SUITE 4:** 1,342 SQ FT (124.7 SQ M)
- SUITE 6:** 1,417 SQ FT (131.6 SQ M)
- SUITE 7:** 1,124 SQ FT (104.4 SQ M)

ALL AREAS ARE MEASURED IN ACCORDANCE WITH IPMS3

■ AVAILABLE ■ OCCUPIED

- PARKING SPACES**
- SUITE 4** - 4 SPACES
 - SUITE 6** - 5 SPACES
 - SUITE 7** - 4 SPACES

* Available on a managed office agreement or a standard commercial lease

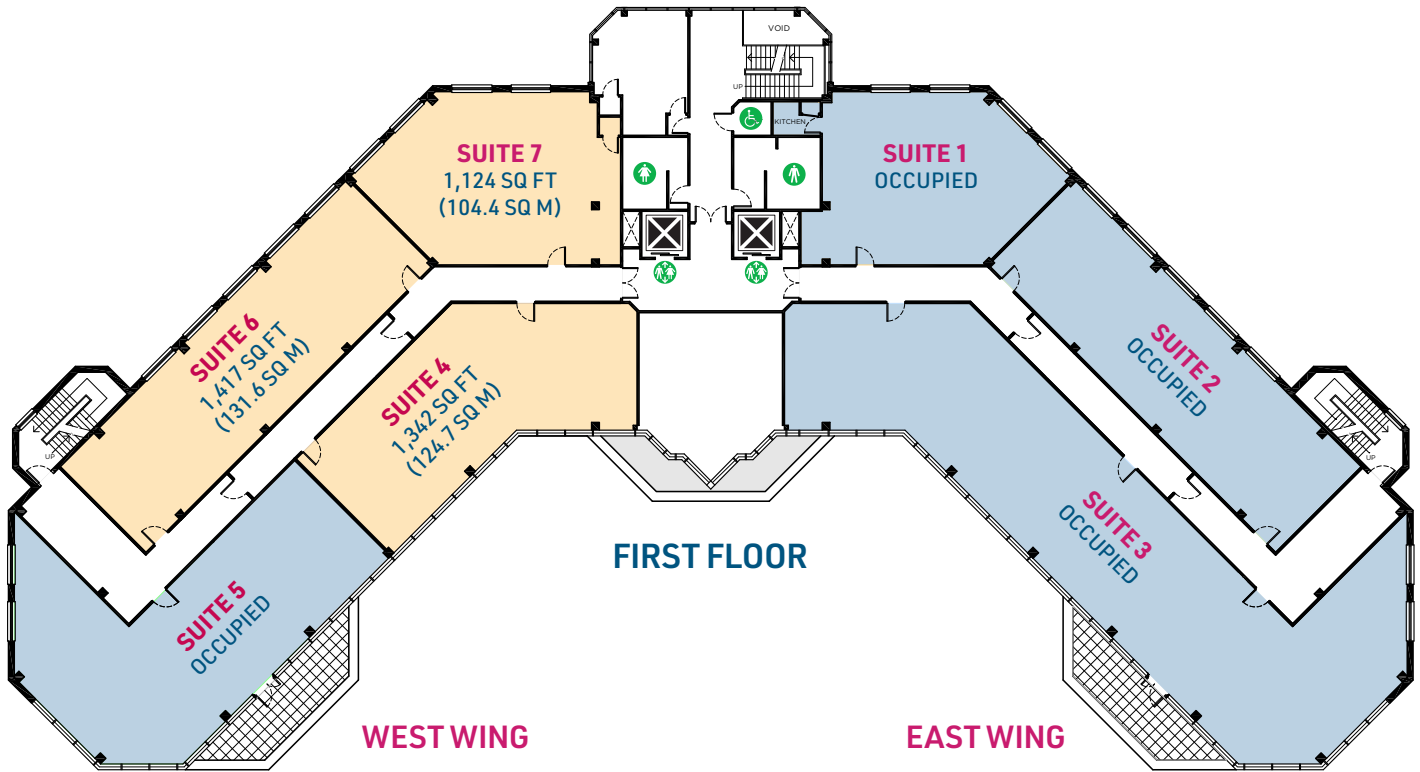

"We have rented office space at Heathrow Boulevard for over 5 years now and have developed a great working relationship with Orbit Southern. The proximity to the Airport allows us easy access to our project sites there and to be close by to our customers, which is vital for our business. It is also very convenient for our staff who regularly travel on business."

Joanne Hughes, Executive Assistant & Office Manager, Beumer Group UK Ltd



HEATHROW BOULEVARD 4 CURRENT AVAILABILITY FLOOR PLANS

* **SECOND FLOOR SPLIT INTO
SMALLER MANAGED OFFICE SUITES**
SUITE B: 420 SQ FT (39 SQ M)

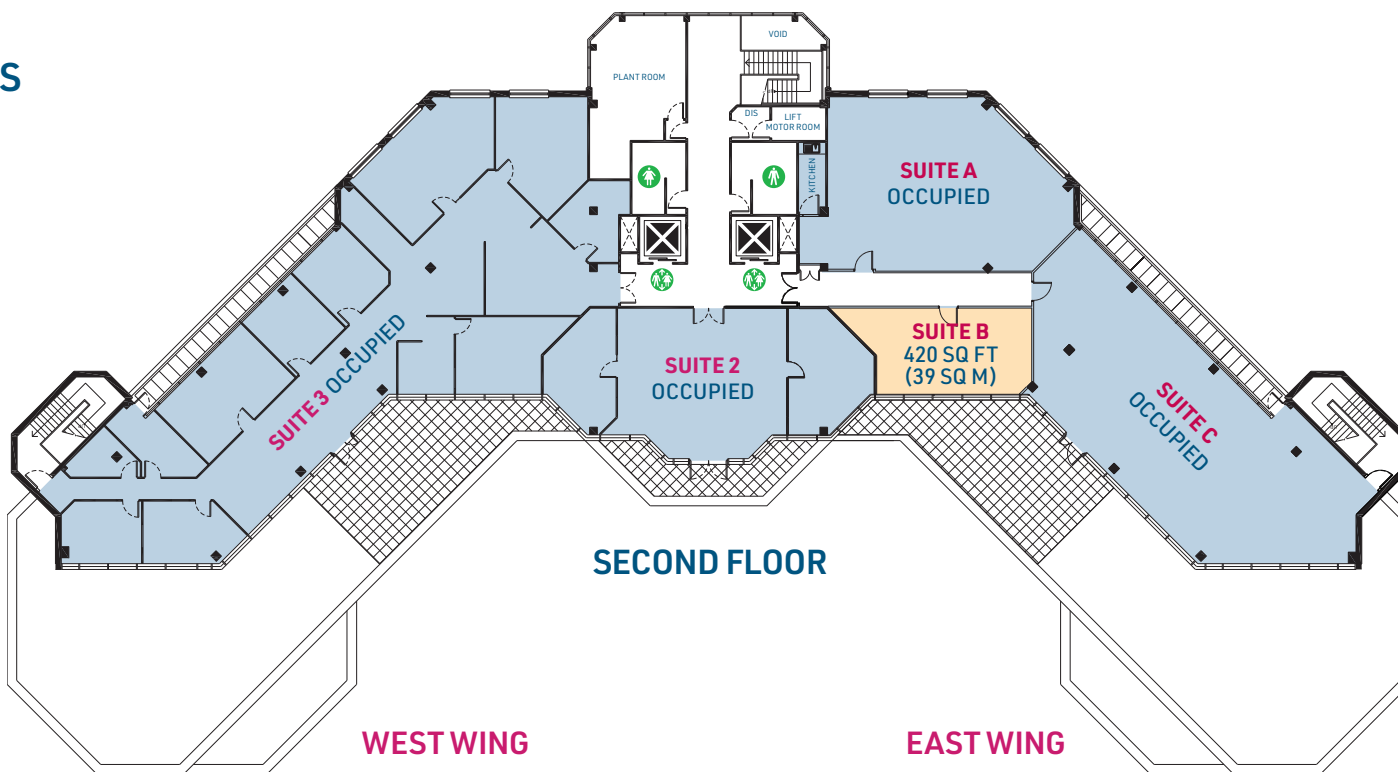

ALL AREAS ARE MEASURED IN
ACCORDANCE WITH IPMS3

■ AVAILABLE ■ OCCUPIED

PARKING SPACES
SUITE B - 2 SPACES

*Also available on a standard commercial lease

"Firstco have based our Airport Engineering Team at Heathrow Boulevard. This places us close to one of our key clients and offers flexible office space within a well-maintained business park. This is our second office with Orbit Southern and we look forward to continuing the relationship further in the future."

Steve Ikin, Associate Director, Firstco Ltd